

FT-01

FT-02

FT-03

FT-04

FT-05-A

FT-05-B

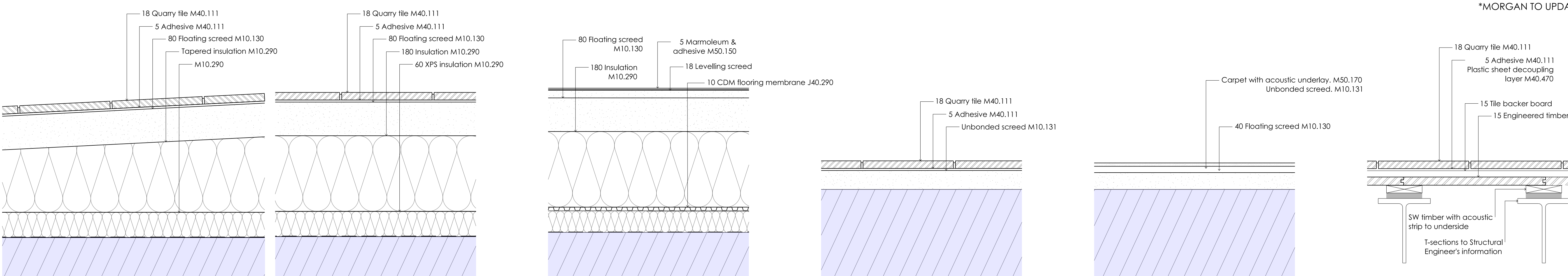

FT-06

FT-07

FT-08

FT-09

FT-10

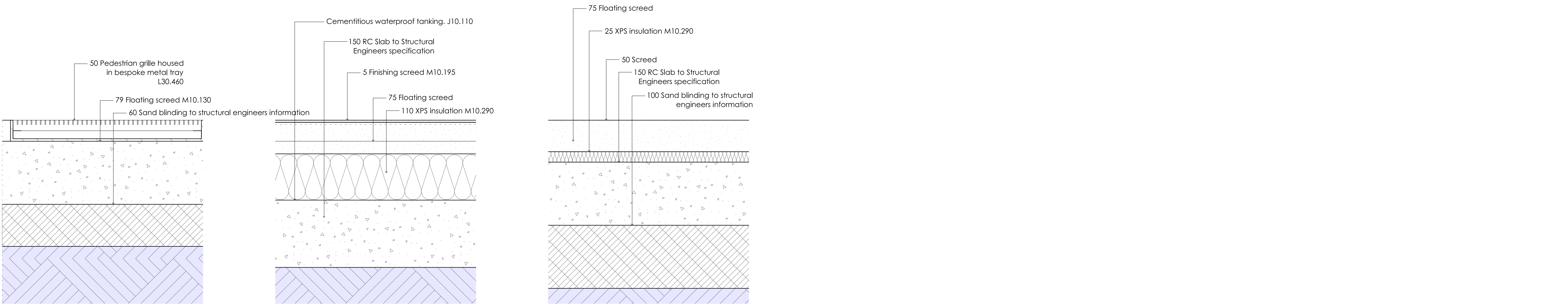

FT-11

FT-12

FT-13

Tender DRAFT

Existing Fabric

General Notes:
All demolition and proposed works are to be undertaken in adherence to SMC conditions and Listed Building Consent conditions.

Jamie Fobert
— Architects
Rochelle, 22 Club Row
London E2 7EY
T: +44 (0) 207 553 6560
mail@jamiefobertarchitects.com

Copyright of Jamie Fobert Architects Ltd 2023

Unless indicated below, this drawing is for information only. Do not scale. Use figured dimensions only. All dimensions to be checked on site.			Project	The Tower of London
Issue/Revision	Date	Rev	Subject	Floor Types
Stage 4	18 07 25	A	Scale	1:5
Tender Draft	24 10 25	B	Original Size	A1
			Date	18 07 25
			Drawing No.	TOL_JFA_01_XX_DW_A_5130